



Farren Road, Coventry, CV2 5EH

Loveitts

PART OF | SHELDON BOSLEY KNIGHT



# Property Description

Loveitts are proud to welcome to the market this three bedroom double bay terraced family home located in the popular area of Wyken and within walking distance of the University hospital, sits this three bedroom double bay terraced family home. The property is extended to the rear and is well presented with a modern refitted kitchen and bathroom. Offered with no upward chain.

The accommodation on offer comprises an entrance hallway with stairs rising to the first floor, a front lounge and an extended kitchen/diner with access out onto the rear garden. To the first floor are two double bedrooms, a single bedroom and a refitted family bathroom.

Outside there are front and rear gardens with a garage to the rear with rear vehicle access.

Call us now to arrange a viewing.







## Key Features

- THREE BEDROOM FAMILY HOME
- EXTENDED MIDDLE TERRACED PROPERTY
- CLOSE TO THE UNIVERSITY HOSPITAL
- MODERN EXTENDED KITCHEN/DINER
- WELL PRESENTED AND DECORATED
- MODERN REFITTED BATHROOM
- GARAGE WITH ACCESS TO THE REAR
- CALL NOW TO ARRANGE A VIEWING
- EPC - C

**Offers Over  
£240,000**





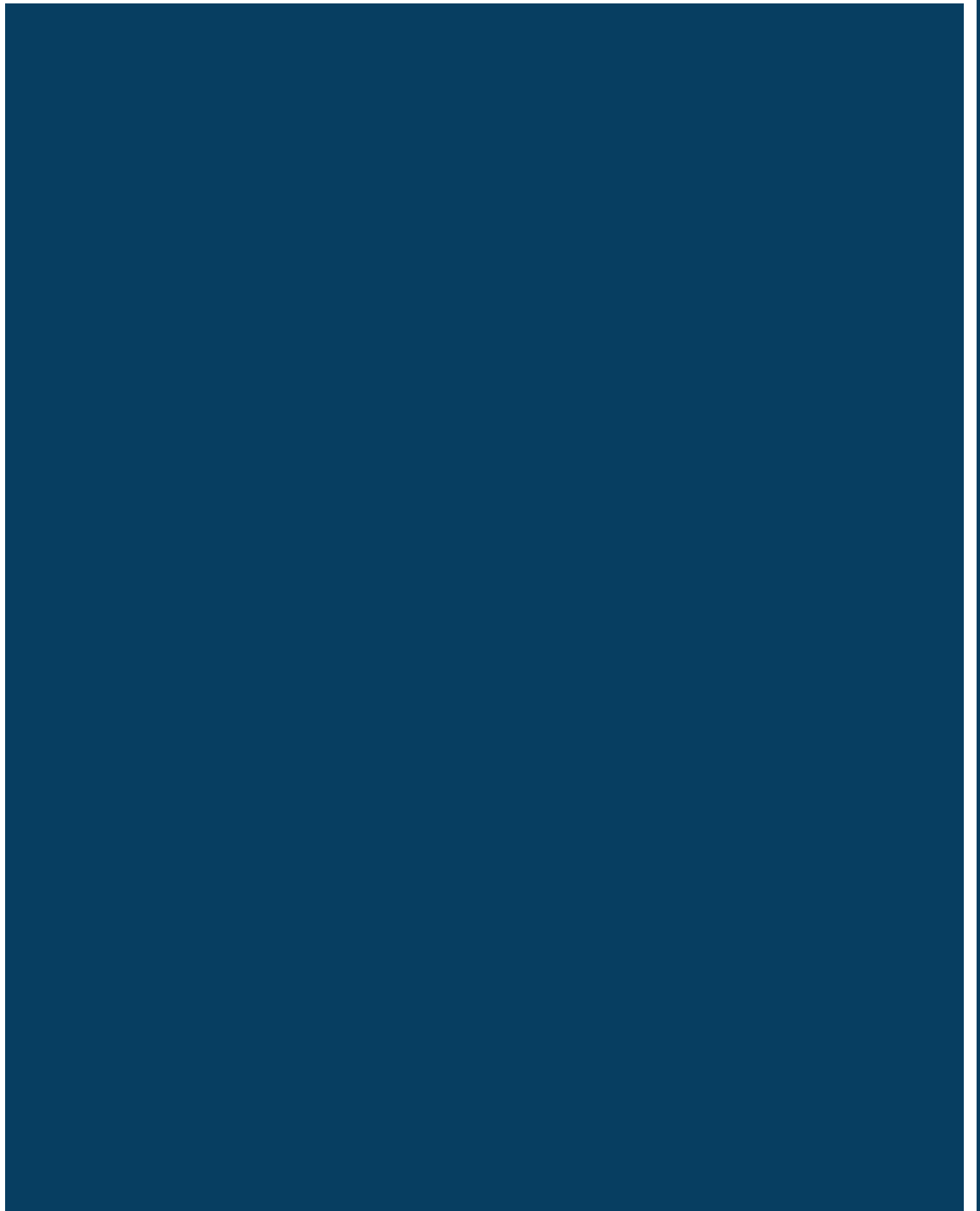





# Floorplan

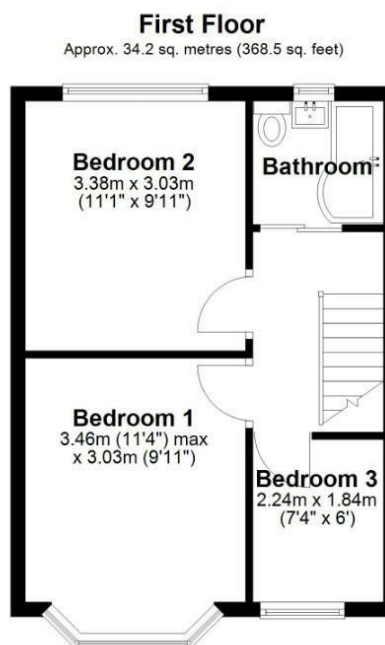
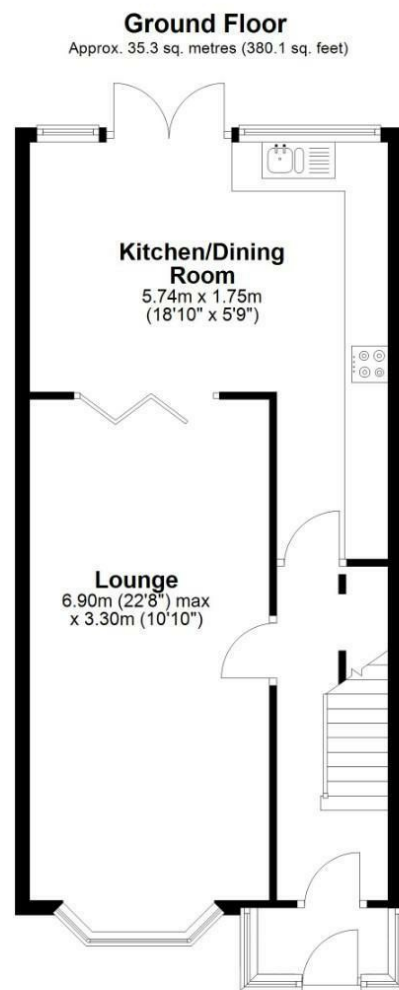

Total area: approx. 69.6 sq. metres (748.6 sq. feet)



EPC Rating - C

Tenure - Freehold

Council Tax Band - B

Local Authority  
Coventry City Council

We routinely refer clients to both our recommended Legal Firm and a panel of Financial Services Providers. It is your decision whether you choose to deal with these companies. In making that decision, you should know that we receive a referral fee



We routinely refer clients to both our recommended Legal Firm and a panel of Financial Services Providers. It is your decision whether you choose to deal with these companies. In making that decision, you should know that we receive a referral fee

**Loveitts**

PART OF | SHELDON BOSLEY KNIGHT